Expanded cork granules

Natural materials for technical solutions

Description

EXPANDED CORK GRANULES is a by-product obtained during the Expanded Insulation Corkboard production. Solution of lightweight filling with acoustic properties for use in screeds, flooring and interior cavity walls.

Advantages

- 100% natural and fully recyclable
- Excellent thermal and acoustic insulation
- Easy to apply
- High durability keeping properties
- Healthier natural product
- CO₂ sink (Carbon Negative)

Product lines

- Size: 1-3; 3-5; 3-10; 3-15 (mm)
- Possible other sizes
- Bags: 250/500 Lt

Product specifications

- Density: 60-70 kg/m³
- Thermal Conductivity: 0,041 W/m.K
- Fire Reaction: Euroclass E



Technical Characterization (mixing formulas/ screed filling)

Product	M150	M250	M400
Cement (Kg/m ³)	151,44	254,63	400,02
Sand (Kg/m ³)	377,67	358,25	339,84
Expanded cork granules 3/10mm (Kg/m ³)	60,93	53,33	58,42
Water (Lt/m ³)	81,36	138,80	202,22

M150

- Density after 28d: 430 Kg/m³
- Mechanical strength after 28d: 0,111 MPa
- Thermal conductivity coefficient of the mixture: $\lambda=0,209$ W/m^{°C}
- Reducing flooring impact noise (thickness 4,5cm): 22 dB

M250

- Density after 28d: 740 Kg/m³
- Mechanical strength after 28d: 0,545 MPa
- Thermal conductivity coefficient of the mixture: $\lambda=0,215$ W/m^{°C}
- Reducing flooring impact noise (thickness 4,5cm): 18 dB

M400

- Density after 28d: 1060 Kg/m³
- Mechanical strength after 28d: 2,234 MPa
- Thermal conductivity coefficient of the mixture: $\lambda=0,319$ W/m^{°C}
- Reducing flooring impact noise (thickness 4,5cm): 20 dB

Application systems: Cavity walls and floors

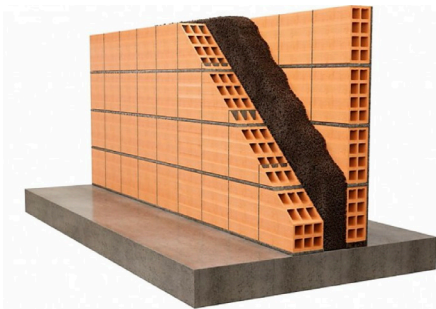

Application systems: Screed filling



Amorim Cork Solutions

Rua Comendador Américo Amorim, 105 — 4535-186 Mozelos, Portugal
 T. +351 227 419 100 E. mail.acs@amorim.com

www.amorimcorksolutions.com